

IF IN DOUBT - ASK!

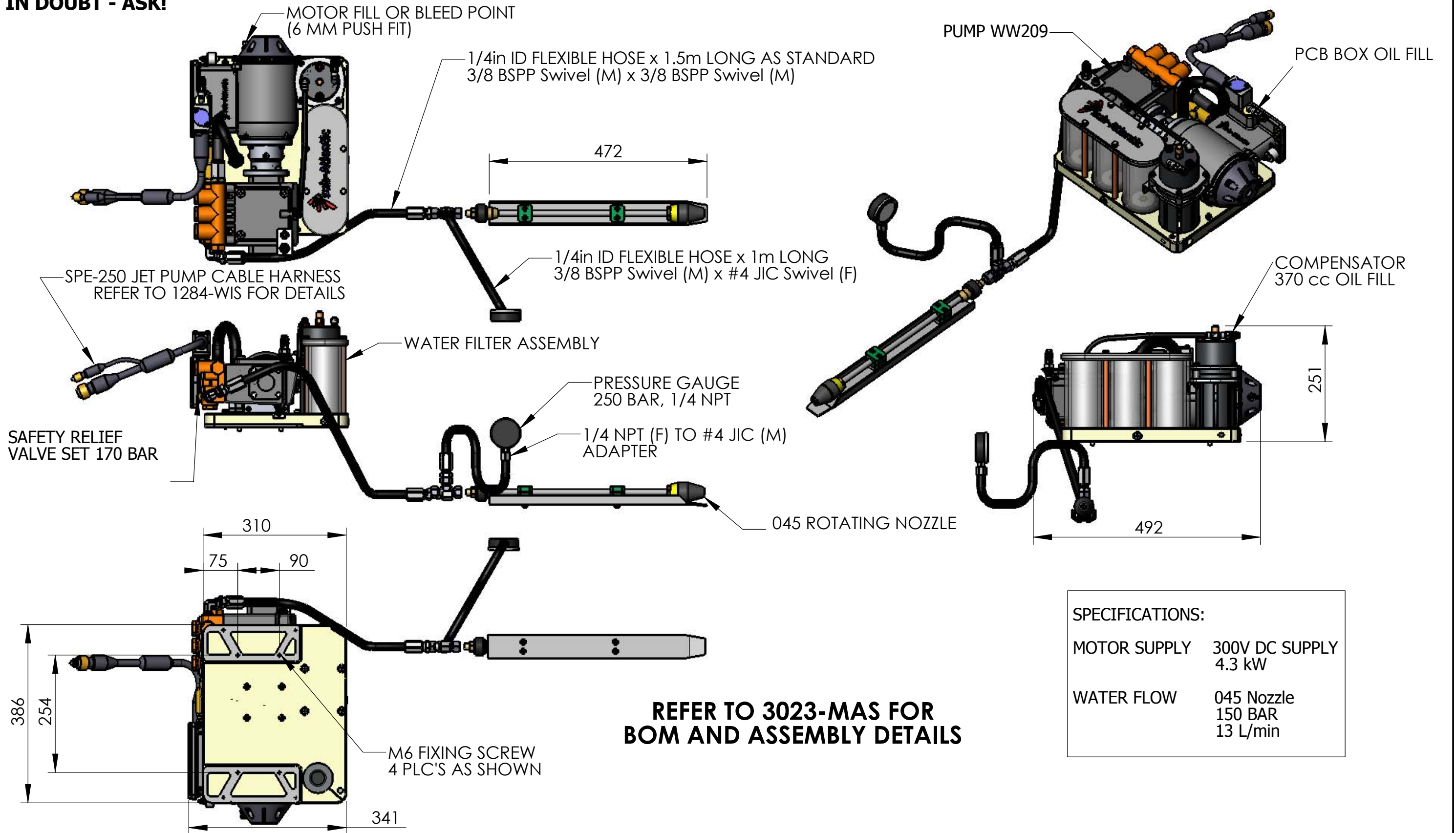

REFER TO 3023-MAS FOR BOM AND ASSEMBLY DETAILS

SPECIFICATIONS:	
MOTOR SUPPLY	300V DC SUPPLY 4.3 kW
WATER FLOW	045 Nozzle 150 BAR 13 L/min

				MATERIAL	WT AIR	WT WATER	<p>Woodburn Road, Blackburn Business Park, Blackburn, Aberdeen. U.K. AB21 0PS Tel: ++44 (0) 1224 798660 Fax: ++44 (0) 1224 798661</p>	PROJECT	ROV TOOLING
				FINISH	-	-		TITLE	WATER JETTER
				USO, TOLERANCES TO BE					GENERAL ARRANGEMENT DRAWING
1	ABO	25/01/08	ISSUED FOR INFORMATION		DRAWN	ABO			Sheet 1 of 1
REV	BY	DATE	DESCRIPTION	APP	DATE	25/01/08		SCALE (UOS)	1:8
RECORD OF REVISIONS					CHECK	LZA	ORIG. SIZE	A3	
					APPRV.	GDU		DOC. No.	4388-GA
					ENGR.	MBL		REV	1